

Protocole Dentotemp

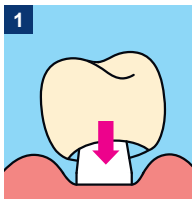

Etape 1 : Préparation de la dent

Moignon dentaire



1 Essai et ajustement d'occlusion

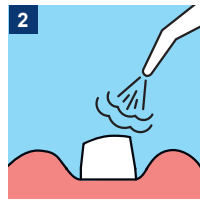

2 Sécher et isoler les surfaces préparées

Pilier implantaire

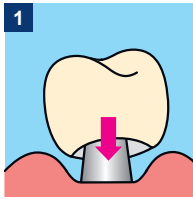

1 Essai et ajustement d'occlusion

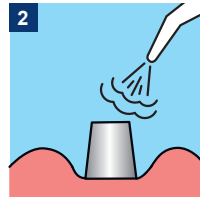

2 Sécher et isoler le pilier implantaire

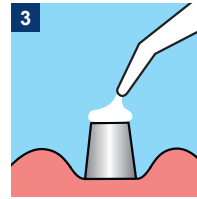

3 Appliquer une fine couche de lubrifiant à base d'eau

Facilite le retrait ultérieur.

Etape 2 : Préparation de la couronne

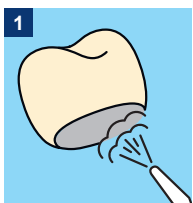

1 Nettoyer et sécher l'intrados

Etape 3 : Application du ciment

Dentotemp seringue automatique

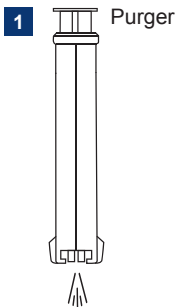

1 Purger

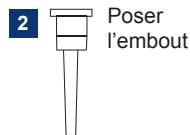

2 Poser l'embout

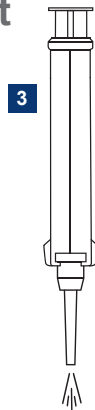

3 Repurger
Amorçage base/catalyseur.



4 Appliquer le ciment dans l'intrados

Le long de la paroi interne du tiers cervical de la restauration. Recouvrir complètement le bord.

Dentotemp seringue manuelle



1 Appliquer des doses équivalentes de base et catalyseur sur un bloc de mélange

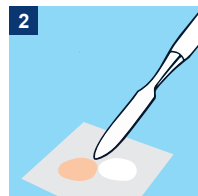

2 Mélanger pendant 20 à 30s



3 Appliquer le ciment dans l'intrados

Le long de la paroi interne du tiers cervical de la restauration. Recouvrir complètement le bord.

Etape 4 : Prise, Excès & Finition

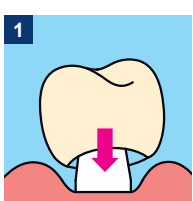

1 Positionner la couronne

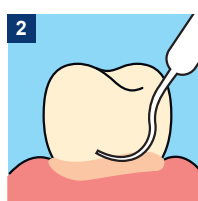

2 Maintenir jusqu'à la phase gel, puis retirer les excès

~ 2 à 2,5 min.

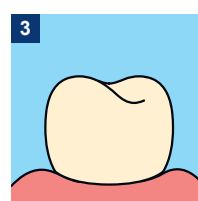

3 Compléter la prise en bouche

~ 4 à 5 min.

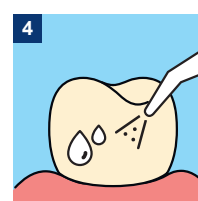

4 Rinçage, contrôle des marges et de l'occlusion

Dentotemp Protocol



Step 1 : Tooth preparation

Tooth abutment

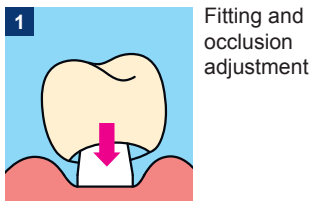

Implant abutment

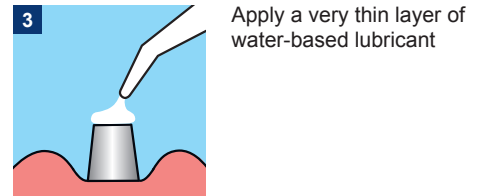
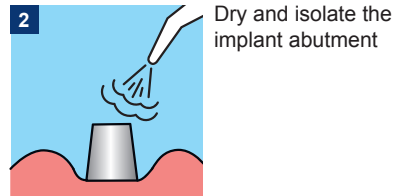
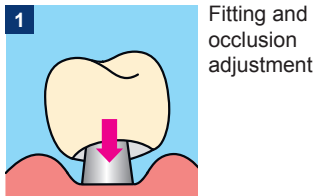

To make later removal easier.

Step 2 : Crown preparation



Step 3 : Cement application

Dentotemp automix syringe

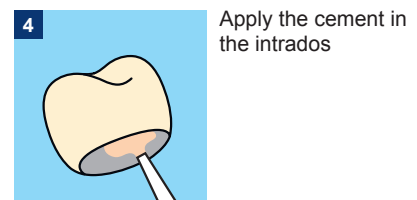
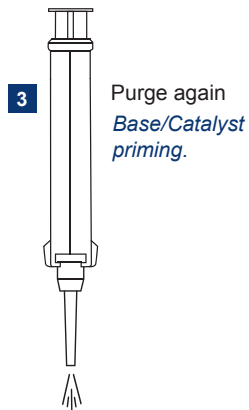
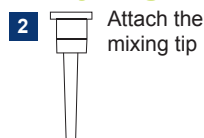
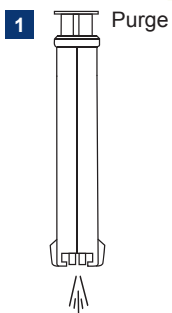

Along the internal wall of the cervical third. Coat the entire margin.

Dentotemp manual syringe

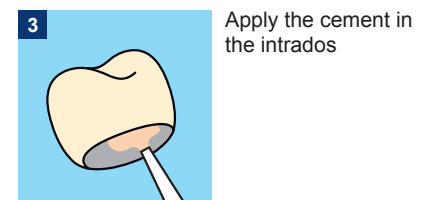
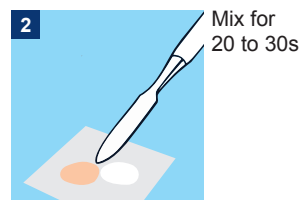
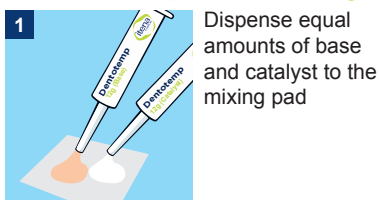

Along the internal wall of the cervical third. Coat the entire margin.

Step 4 : Setting, Excess & Finishing

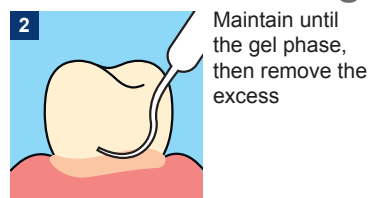
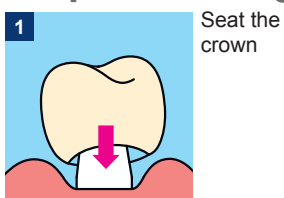

~2 to 2.5 min.

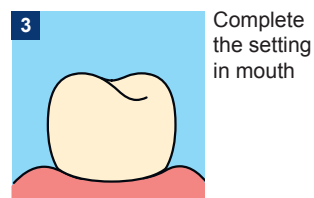

~4 to 5 min.

