

Protocole Total C-ram

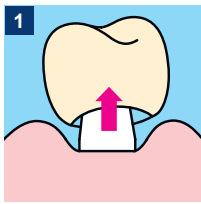

Etape 1 : Préparation de la dent



1 Retirer la restauration provisoire

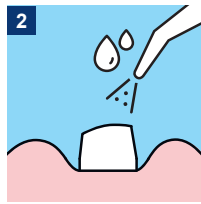

2 Rincer abondamment

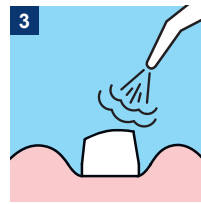

3 Sécher modérément

Note: Ciment temporaire sans eugéol

(Ne pas dessécher)

Etape 2 : Préparation de la restauration / couronne

Zircone

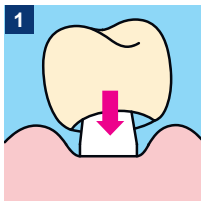

1 Essayer la couronne

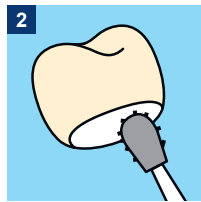

2 Sablage & Nettoyage



3 Appliquer un Primer MDP

(vérifier l'ajustement, décontaminer l'intrados si besoin)



(Type Iperbond Max)

Céramique

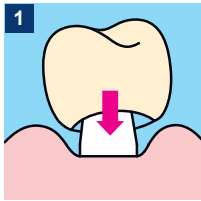

1 Essayer la couronne



2 Acide fluorhydrique 9%



(type Ceram-Etch)



3 Rinçage + séchage



4 Silan-It

(vérifier l'ajustement, décontaminer l'intrados si besoin)



Etape 3 : Application du ciment

Total C-Ram seringue automix

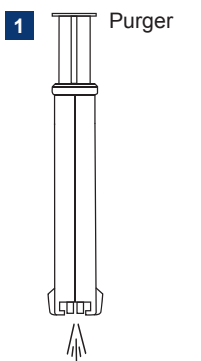

1 Purger

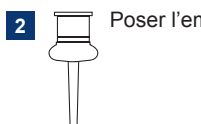

2 Poser l'embout

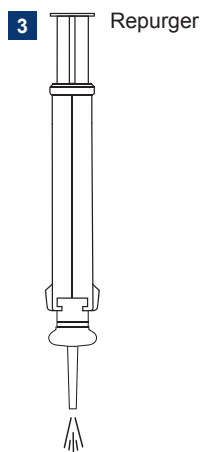

3 Repurger

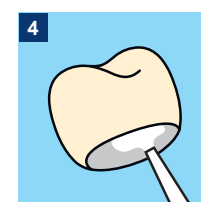

4 Déposer le ciment

(Inlay/Onlay : dans la cavité.
Couronne : sur le moignon ou intrados.
Couvrir toutes les surfaces)

Etape 4 : Polymérisation, Excès & Finition

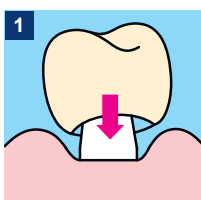

1 Positionner la restauration

(Pression modérée, excès visible)

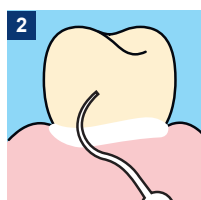

2 Attendre le gel & retirer les excès

(~1,5 min ou tack-cure 2 s)

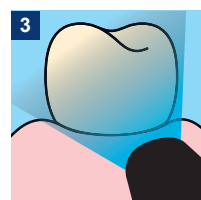

3 Photo-polymériser

(20 s par face, marges incluses)

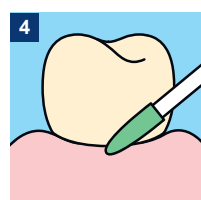

4 Finition

(Strips interproximaux, polissage des bords, contrôle de l'occlusion)

Total C-ram protocol



Step 1 : Tooth Preparation

1 Remove the temporary restoration

2 Rinse thoroughly

3 Gently air-dry
(Do not desiccate)

Note: Eugenol-free temporary cement

Step 2 : Restoration / Crown Preparation

Zirconia

1 Try-in the crown

2 Sandblasting & Cleaning

3 MDP primer
(Such as Iperbond Max)

(Verify fit, decontaminate the intaglio if needed)

C eric

1 Try-in the crown

2 Hydrofluoric acid 9%
(Such as Ceram-Etch)

3 Rinsing + drying

4 Silan-It

(Verify fit, decontaminate the intaglio if needed)

Step 3 : Cement Application

Total C-Ram: Automix syringe

1 Bleed

2 Place the mixing tip

3 Bleed again

4 Dispense cement
(Inlay/Onlay: into the preparation.
Crown: onto the prepared tooth or into the crown. Cover all surfaces)

Step 4 : Polymerization, Excess & Finishing

1 Seat the restoration
(Steady, moderate pressure; excess visible)

2 Wait for gel & remove excess
(~1,5 min or tack-cure 2 s)

3 Light-cure
(20 s per surface, margins included)

4 Finishing
(Interproximal finishing strips, polish margins, check occlusion)